

## Single Patient Breast Pump Collection Set

Product code 10091, 10092

Compatible with Clinical Breast Pumps

### Please Read Before Use

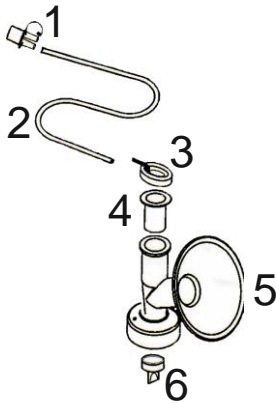

1. *Tubing Adapter*
2. *Tubing*
3. *Barrier Cap*
4. *Protective Barrier*
5. *Breast Flange*
6. *Valve*



### Instructions for Use

- First read your breast pump user instructions.
- Assemble the kit as shown in picture ensuring that bottle is attached.
- Center Breast Flange over your nipple.
- Press lightly against your breast to make airtight seal.
- Set suction as per breast pump instructions and angle Breast Flange down a little so milk flows into the bottle.

### Cleaning instructions

- After use clean only parts 4, 5 and 6 (Please refer to drawing).
- Wash in warm soapy water or dishwasher and sterilize using a steam sterilizer, microwave sterilizer, cold water sterilizing solutions, boiling water for 10 minutes or autoclave at 121C for 20 minutes/134C for 5 minutes.
- Dry thoroughly and store in a dry airtight container.
- Parts 1, 2 and 3 do not need to be washed/sterilized as the barrier protects them.

### Please keep these instructions safe for future reference

This Milk Collection System is **sterile** unless the package is opened or damaged. Do not use the package if package is damaged. For hygienic reasons, this product should never be shared between mothers or resold from mother to another.

